

CURVED BACK BENCH

- MODEL #1103-06 - 6ft. Bench (65 lbs)
- MODEL #1103-08 - 8ft. Bench (70 lbs)
- MODEL #1103-15 - 15ft. Bench (112 lbs)
- MODEL #1103-21 - 21ft. Bench (165 lbs)
- MODEL #1103-27 - 27ft. Bench (218 lbs)

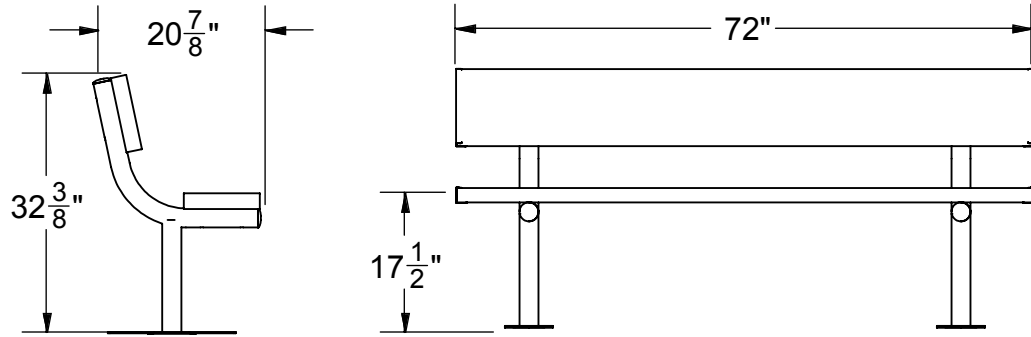

SPECIFICATIONS:

SEAT AND BACK FRAME: 2-3/8" O.D. galvanized steel. Each frame is all welded construction.

SEAT AND BACKREST: Anodized aluminum planking. Available 6', 8', 15', 21' & 27' lengths.

FINISH: All frames are galvanized. All hardware is zinc-plated for long, rust-resistant service.

M3 SURFACE MOUNT SHOWN

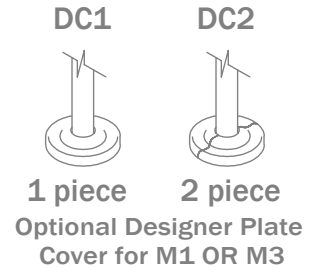
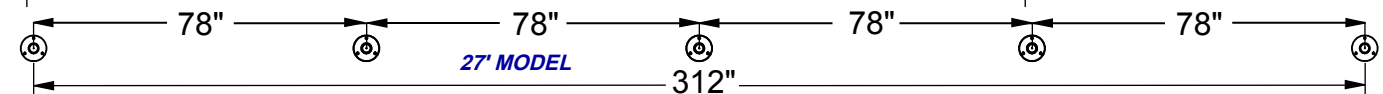
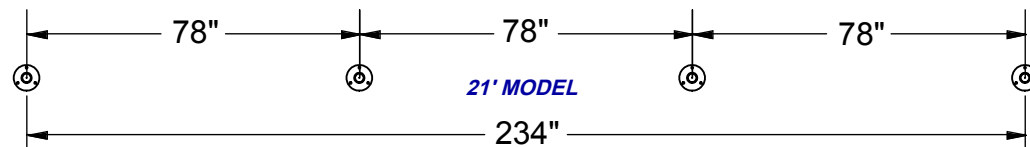
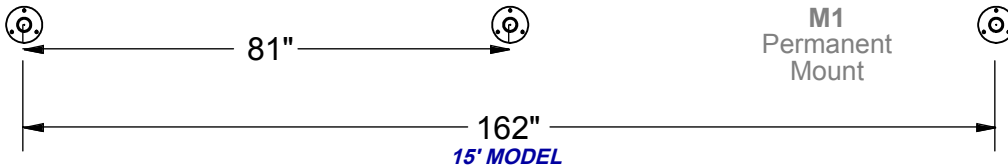
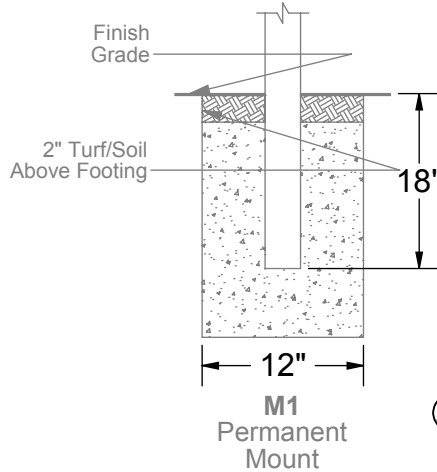
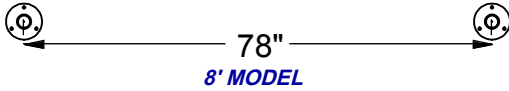
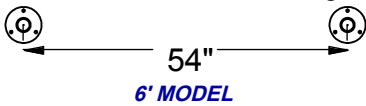
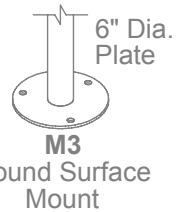

Date: 4/2/15
Rev: C 7/20/20
Drawn: JBN
Sheet: 1 of 3

SPECIFICATION / INSTALLATION INSTRUCTIONS

ALUMINUM PLAYERS BENCH WITH BACK

MODEL NO.

1103

M1 IN-GROUND MOUNT
ADJUST TO GET TOP OF SEAT AT 18" ABOVE FINISHED GRADE.

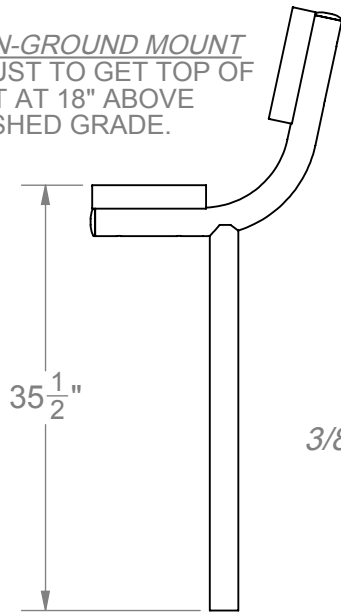

1103-M1

3/8" Hex Bolt & Nut

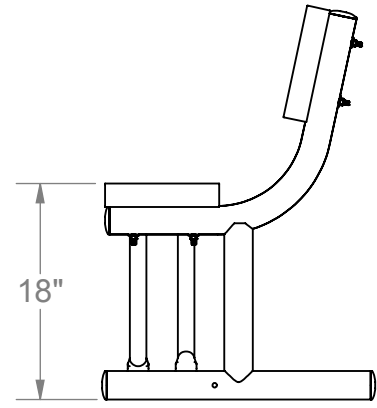
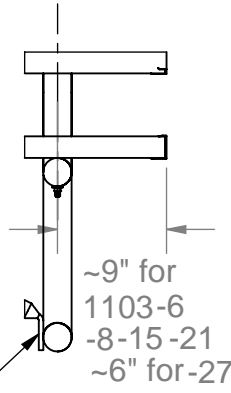

1103-M2

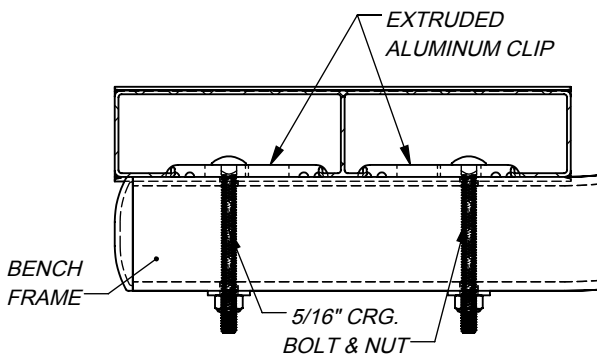

DETAIL A
M2 ALUMINUM CLIP
FRAME INSTALL

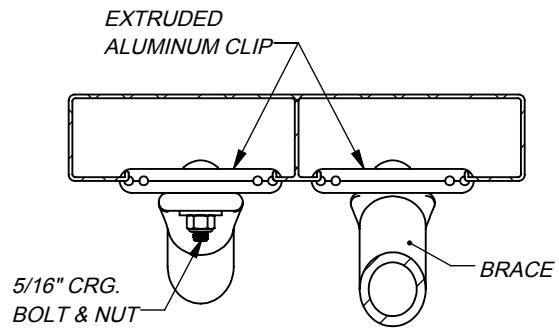

DETAIL B
M2 ALUMINUM CLIP
BRACE INSTALL

M1 & SURFACE MOUNT	1103-06/08	1103-15	1103-21	1103-27
Component Description	Qty.	Qty.	Qty.	Qty.
Aluminum Plank Anodized	2-6' or 8'	2-15'	2-21'	2-27'
Bench Frame Assembly	2	3	4	5
Aluminum Plank Cap	4	4	4	4
#10 x 3/4" Tek Drive Screw	8	8	8	8
Aluminum Plank Clip	8	12	16	20
5/16"-18 x 3-1/2" Carriage Bolt	8	12	16	20
5/16"-18 Lock Nut - Nylock	8	12	16	20
5/16"-18 Washer	8	12	16	20
Optional Surface Mount Plate	2	3	4	5

FOR PORTABLE MOUNT	1103-06/08	1103-15	1103-21	1103-27
Component Description	QTY	QTY	QTY	QTY
Bench Frame Assembly	2	3	4	5
Brace Pipe	2	4	6	8
Aluminum Plank Cap	4	4	4	4
#10 x 3/4" Tek Drive Screw	8	8	8	8
Aluminum Plank Clip	12	20	28	36
5/16"-18 x 3" Carriage Bolt	8	12	16	20
5/16"-18 x 1-1/4" Carriage Bolt	2	4	6	8
5/16"-18 Lock Nut - Nylock	10	16	22	28
5/16" Washer	10	16	22	28
3/8"-16 x 3 Hex Bolt	2	2	2	2
3/8" Lock Nut - Nylock	2	3	4	5
3/8"-16 x 3-1/2" Hex Bolt		1	2	3
3/8" Washers	4	6	8	10



Date: 4/2/15
Rev: C 7/20/20
Drawn: JBN
Sheet: 2 of 3

SPECIFICATION / INSTALLATION INSTRUCTIONS

ALUMINUM PLAYERS BENCH WITH BACK

MODEL NO.

1103

INSTALLATION INSTRUCTIONS:

Determine the model of bench to be installed. The 6' & 8' bench (1103-06 & -08) require 2 seat supports each, the 15' bench (1103-15) requires 3 seat supports, the 21' bench (1103-21) requires 4 seat supports, and the 27' bench requires 5 seat supports. Note: Permanent Players Benches require a concrete footing for permanent installation.

1. Use Detail B to determine the distance between seat supports. (See page 1 for mounting options).
2. Assemble & align end caps on aluminum planks. Use self-tapping screws to secure end caps.
3. First install plank clips to each of the seat supports using 5/16" x 3" carriage bolts through the top of the clip through the mounting hole(s) in seat support. Secure w/ washer & 5/16" lock nut. Do not tighten nut at this time, just install until finger tight only. Turn the plank clips perpendicular to the frame arm (See Detail A).
4. Attach seat plank by placing the plank over the plank clips on the frames. Turn each plank clip 90° to capture the edges of the plank channels & tighten lock nuts slightly so the plank clip does not disengage but plank can still be moved through the clip. Center plank on frames to have equal over hang on each end. Align front edge of the plank to extend 1/2" beyond the front end of the frame.
5. Following the same steps above, install the back plank to the back of the bench frame as required.

For M2 option Models:

6. Attach a brace pipe to a bench frame at the bottom w/ a 3/8" x 3" hex bolt & nut. Repeat for other bench frame. (See Detail B). Note: On the 1103-15 use a 3/8" x 3-1/2" hex bolt on the middle bench frame to attach 2 braces. On the 1103-21 use a 3/8" x 3-1/2" hex bolt on the middle two legs. On the 1103-27 use a 3/8" x 3-1/2" hex bolt on middle 3 frames.
7. Attach the other end of the brace pipe to the bottom of the aluminum plank w/ 2 plank clips, & 5/16" x 1-1/4" carriage bolt & nut. Repeat for other bench frame. (See Detail B) Note: On the 1103-15, use four clips, twelve on the 1103-21, and use sixteen on the 1103-27.
8. Square plank to frame & tighten all hardware securely so the plank clips are firmly in contact w/ the mounting surface.

For M1 option Models. (PW recommends an 18" x 18" x 24" deep footing as a minimum. Please check with your local building authority before pouring concrete.)

9. Lower the leg supports of the assembled bench into the center of the holes & shim from below or fill such that the top of the seat plank is 18" above finish grade. Plumb the post to true vertical & brace. Pour concrete to within 2" of finish grade. Allow concrete to set for 3 days before removal of bracing and completion of installation. Grout the footing up to the finish grade & crown slightly, this allows water to drain away from the post.

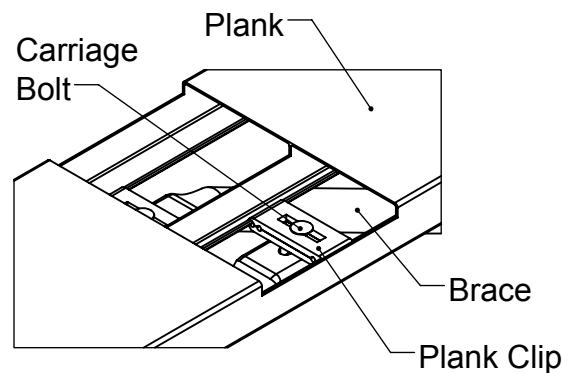
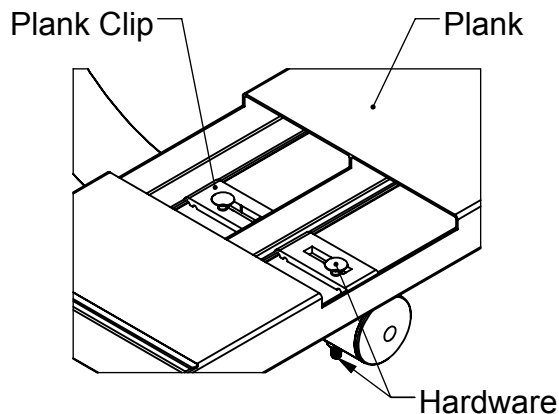

	Date: 4/2/15	SPECIFICATION / INSTALLATION INSTRUCTIONS ALUMINUM PLAYERS BENCH WITH BACK
	Rev: C 7/20/20	
	Drawn: JBN	MODEL NO.
	Sheet: 3 of 3	1103