

# SITE FURNISHINGS

**MODEL 1120-06** 6 FT. PICNIC TABLE (250 LBS)  
**MODEL 1120-08** 8 FT. PICNIC TABLE (325 LBS)

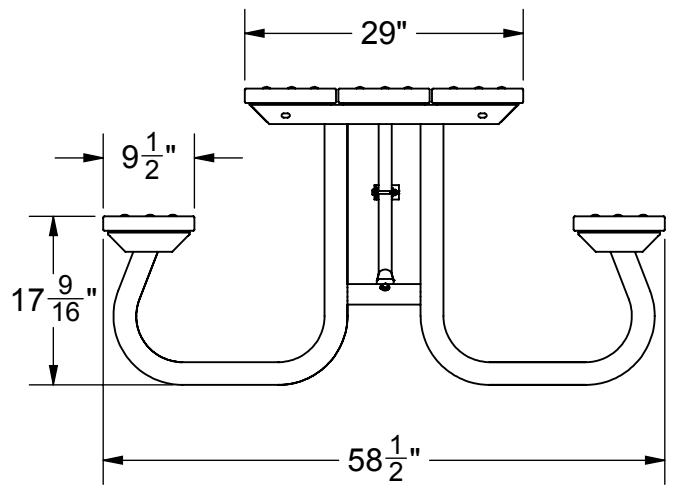
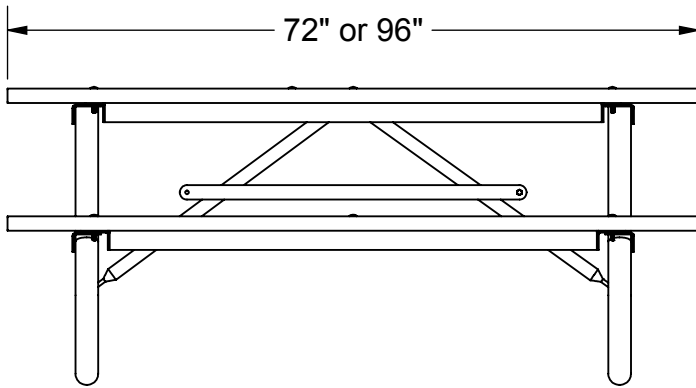

## Specifications

**General:** A heavy-duty table with galvanized steel frames and maintenance-free recycled plastic seats and table planks.

**Heavy-Duty J-Frames:** Formed and welded into a single unit consisting of 2-3/8" O.D. galv. steel, 3" x 2" x 3/16" steel angle seat and table supports. Two frames are required per table. All welded construction of frames eliminates excess hardware and simplifies assembly. The wide end-frame design allows anti-tipping protection without permanent anchoring.

**Recycled Plastic Planks:** Recycled HDPE plastic. This material has exceptional resistance to corrosive substances and other environmental stresses and weather. This material requires no waterproofing, painting, staining, or similar maintenance when used outdoors.

**Plank Spline:** Plank support splines are welded from 2" x 2" x 3/16" angle.

**Brace Pipe:** Flattened, punched, and formed from 1-3/8" O.D. galv. steel tube.

**Warranty Period:** 20 year warranty on recycled plastic planks. 3 year warranty on all other parts.



SITE FURNISHINGS

SCALE: N.T.S.	SPECIFICATION / INSTALLATION INSTRUCTIONS
DATE: 4/13/16	
DRAWN: MT	<b>MODEL 1120-06 &amp; -08</b>
Rev: SS81617	
SHEET: 1 of 3	

**Installation Instructions:**

**NOTE: FINGER TIGHTEN ONLY UNTIL ASSEMBLY IS COMPLETE.**

- 1) **Insert 5/16" x 2-1/2" carriage bolts into three planks using the pre-drilled holes provided so the bolt heads are seated. Note: On the top-middle plank, use a 5/16" x 3" carriage bolt in the center hole. This will be used for the brace pipe later during installation.**
- 2) **Lay the three planks upside down on a hard, clean surface (to keep bolts seated) with the bolt threads facing up.**
- 3) **Place the 6' table spline (55-3/4") or 8' table spline (79-3/4") support angle over the exposed bolt threads. Note: Align all angle supports in the same direction.**
- 4) **Stand leg frame over bolt threads with angle facing in.**
- 5) **Attach leg frame to planks with 5/16" flat washer, 5/16" split washer, and 5/16" nut.**

**Leg frame assembly is completed. Attach other leg frame in the same manner.**

- 6) **Attach 35-1/2" or 45-1/2" brace pipe to center plank with 5/16" x 3" carriage bolt using 5/16" split washer, fender washer, and flat nut. (Finger tighten only until assembly is completed.)**
- 7) **Attach other end of brace to the leg frame spacer angle with 3/8" x 1" hex head bolt, flat washer, and nut. Finger tighten only.**
- 8) **Use 55-3/4" or 79-3/4" seat supports for the installation of the seat planks. Line up holes on the leg frame, spline, and plank. Insert bolts through until they are seated. Attach with 5/16" x 2-1/2" carriage bolts as in Step 5.**
- 9) **Tighten all bolts. Note: Tighten all bolts that are seated in the recycled plank slowly so you will not strip out the shoulder of the bolt.**
- 10) **Flip table over carefully into upright position.**

**NOTE: PLANK SPLINES FOR THE 8' SEATS ARE STEEL. ALL OTHER SPLINES ARE ALUMINUM.**

**INSTALLING RECYCLED PLASTIC PLANKS:**

**It is important that when installing the recycled plastic planks that you DO NOT tighten any bolts past finger tight when assembling. After assembly is complete and all hardware is installed finger tight, then go back and SNUG all nuts and bolts to complete assembly. It is important to watch for movement on the recycled plastic when doing the final tightening sequence. Planks may become out of alignment if you over-tighten hardware.**



SITE FURNISHINGS

SCALE: N.T.S.	<b>SPECIFICATION / INSTALLATION INSTRUCTIONS</b>
DATE: 4/13/16	
DRAWN: MT	
Rev: SS81617	<b>MODEL 1120-06 &amp; -08</b>
SHEET: 2 of 3	

The Plank, Spline, and J-Frame are bolted together

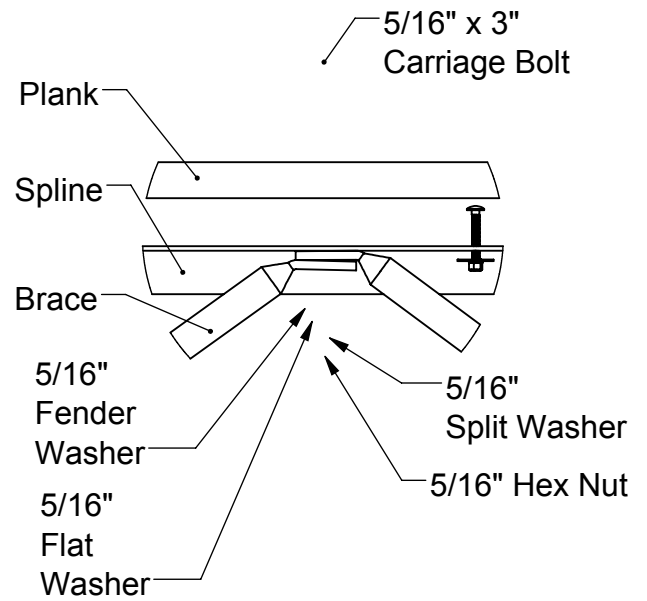
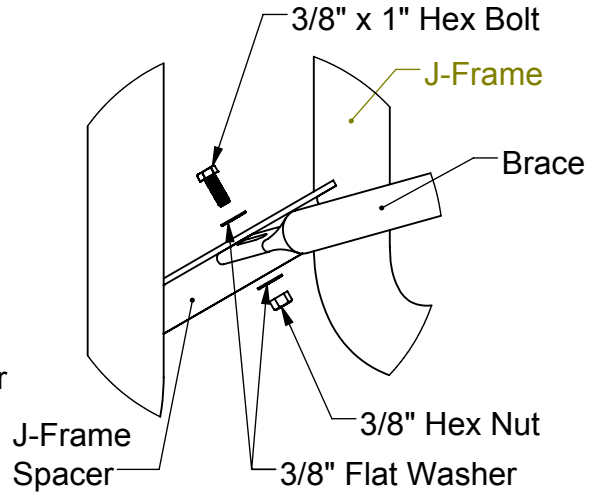
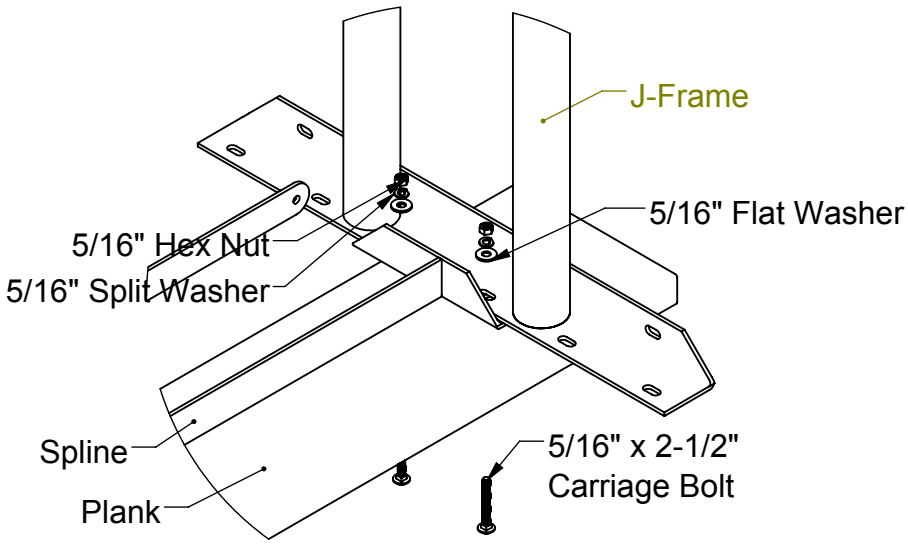

MODEL NO. 1120-06 & -08			
ITEM	-06	-08	MATERIAL
1	5		6' RECYCLED PLASTIC PLANKS
2		5	8' RECYCLED PLASTIC PLANKS
3	2	2	J-FRAME
4	5		6' PLANK SPLINE (3) Alum. & (2) steel
5		5	8' PLANK SPLINE (3) ALUM. AND (2) STEEL
6	2		BRACE PIPE (35-3/4")
7		2	BRACE PIPE (45-3/4")
8	1	1	5/16" x 3" CARRIAGE BOLT
9	24	24	5/16" x 2-1/2" CARRIAGE BOLT
10	25	25	5/16" FLAT WASHER
11	25	25	5/16" HEX NUT
12	25	25	5/16" SPLIT WASHER
13	2	2	3/8" x 1" HEX BOLT
14	4	4	3/8" FLAT WASHER
15	2	2	3/8" NYLOCK NUT
16	1	1	5/16" x 1-1/2" FENDER WASHER



SITE FURNISHINGS

SCALE: N.T.S.  
 DATE: 4/13/16  
 DRAWN: MT  
 Rev: SS81617  
 SHEET: 3 of 3

**SPECIFICATION / INSTALLATION INSTRUCTIONS**

**MODEL 1120-06 & -08**

# Pick Ticket

Internal use only return to office with packet

Shipping to pull Plank, Braces, and Hardware. Fabrication to provide table legs if shortages occur notify office immediately.

<b>MODEL NO. 1120-06 &amp; -08</b>			
<b>ITEM</b>	<b>-06</b>	<b>-08</b>	<b>MATERIAL</b>
1	5		6' RECYCLED PLASTIC PLANKS
2		5	8' RECYCLED PLASTIC PLANKS
3	2	2	J-FRAME
4	5		6' PLANK SPLINE (3) Alum. & (2) steel
5		5	8' PLANK SPLINE (3) ALUM. AND (2) STEEL
6	2		BRACE PIPE (35-3/4")
7		2	BRACE PIPE (45-3/4")
8	1	1	5/16" x 3" CARRIAGE BOLT
9	24	24	5/16" x 2-1/2" CARRIAGE BOLT
10	25	25	5/16" FLAT WASHER
11	25	25	5/16" HEX NUT
12	25	25	5/16" SPLIT WASHER
13	2	2	3/8" x 1" HEX BOLT
14	4	4	3/8" FLAT WASHER
15	2	2	3/8" NYLOCK NUT
16	1	1	5/16" x 1-1/2" FENDER WASHER

