

ECONOMY BACKSTOP

MODEL #1201-10 Permanent Hooded Backstop.

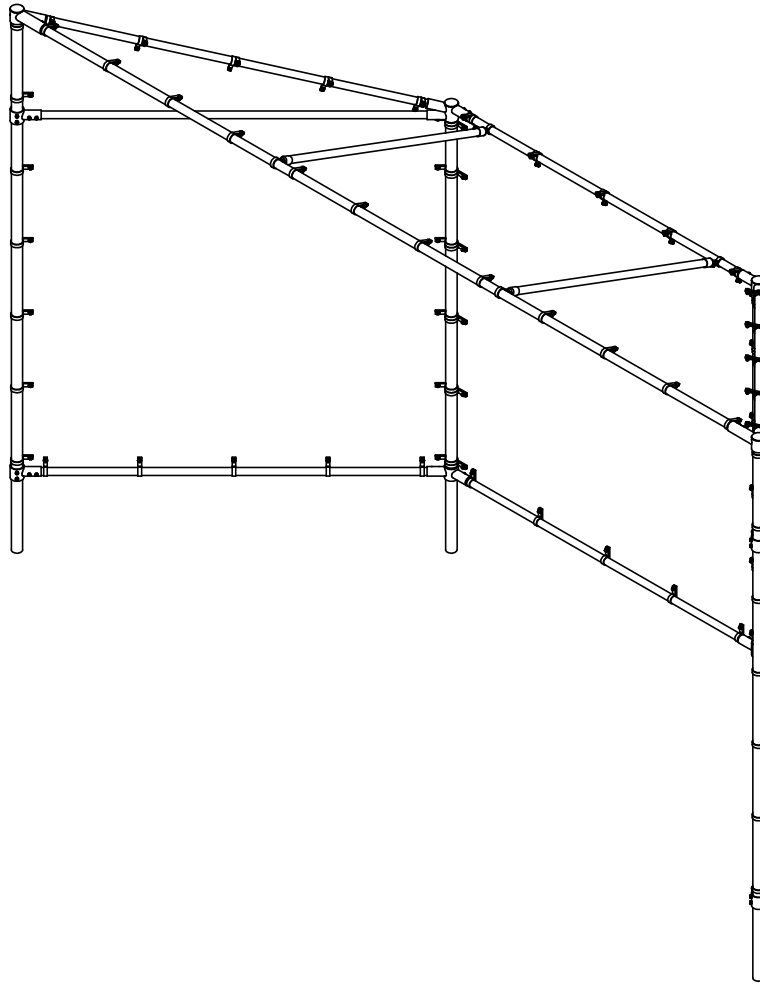

Specifications:

General: A heavy duty, all galvanized steel backstop shipped unassembled with all parts and instructions necessary for quick assembly. Model 1201-10 is permanent. For portable model, use 1202-10.

Materials: All pipe is galvanized steel. Sizes given are outside diameter. Exposed ends are capped.

Description:	Post Size
Vertical Posts	2-3/8"
Horizontal Rails	1-5/8"
Bottom Horizontal Rails	1-5/8"
Top Hood Rails	1-7/8"



Date: 7/26/2017

Rev: A

Drawn: BDYE

Sheet: 1 of 11

PRODUCT NAME

ECONOMY BACKSTOP

MODEL NO.

1201-10

BOM

ITEM NO.	PART NUMBER	DESCRIPTION	QTY.
1	ASA-500-12AD-A1	12AD-A1 FITTING	4
2	ASA-502-12AD-A3	12AD-A3 FITTING	2
3	ASA-503-12AD-A4	12AD-A4 FITTING	1
4	ASA-504-12AD-A5	12AD-A5 FITTING	1
5	ASA-505-12AD-Z1	12AD-Z1 FITTING	1
6	ASA-506-12AD-Z2	12AD-Z2 FITTING	1
7	RT-003-1210-138-G	FRONT VERTICAL POSTS 2-3/8" DIA.	2
8	RT-001-1210-114-G	REAR VERTICAL POSTS 2-3/8" DIA.	2
9	RT-002-1210-87-G	BOTTOM HORIZONTAL RAILS 1-5/8" DIA.	6
10	RT-004-1210-88.5-G	TOP SIDE HOOD RAILS 1 7/8"DIA.	2
11	RT-005-1210-212.5-G	HOOD CROSSBAR 1 7/8" DIA.	1
12	RT-006-1210-62.25-G	CENTER HOOD SUPPORT 1 5/8"DIA.	2
13	HWSC3858	3/8 X 5/8 SET SCREW ZINC	56
14	HWFLWA38	3/8" USS FLAT WASHER	4
15	HWLN38	3/8"-16 LOCK NUT	4
16	HWCB38114	3/8-16 X 1 1/4 CARRIAGE BOLT ZINC (5-9/16 BRACE BANDS)	4
17	HWCB5161	5/16-18 X 1 CARRIAGE BOLT GRADE 2 ZINC	96
18	HWFLWA516	5/16 FLAT WASHER	96
19	HWLN516	5/16 NYLOK NUT ZINC	96
20	VCIRAILEND158	1 5/8 ID RAIL END	4
21	VCIBB163	1 5/8" BRACE BAND	2
22	VCIBB178	1 7/8" BRACE BAND	2
23	VCITEN238	2 3/8" TENSION BAND	38
24	VCITEN158	1 5/8" TENSION BAND	47
25	VCITEN178	1 7/8" TENSION BAND	11
26	VCITBAR8	8' TENSION BAR	4
27	VCITBAR10	10' TENSION BAR	2
28	HWDS1012	#10 X 1/2 RD HD U - DRIVE SCREW ZINC	30

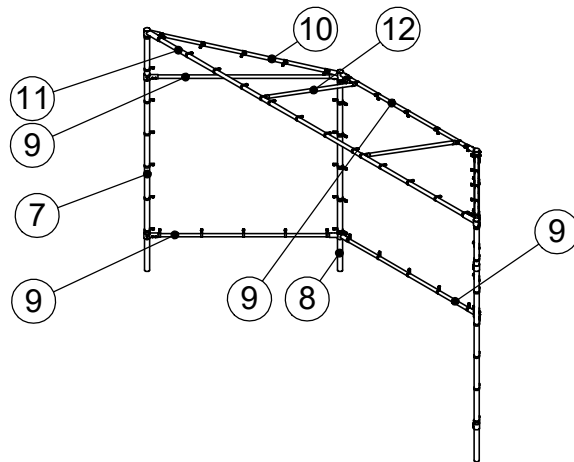

Date: 7/26/2017
 Rev: A
 Drawn: BDYE
 Sheet: 2 of 11

PRODUCT NAME

ECONOMY BACKSTOP

MODEL NO.

1201-10

Fittings by Item Numbers

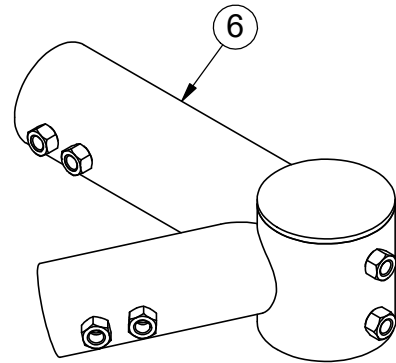
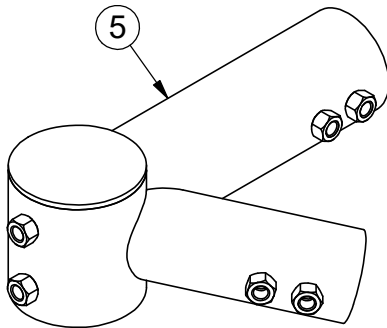
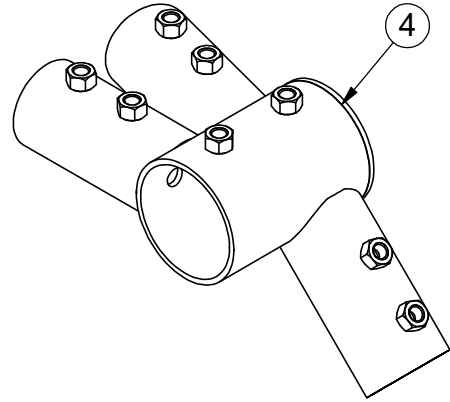
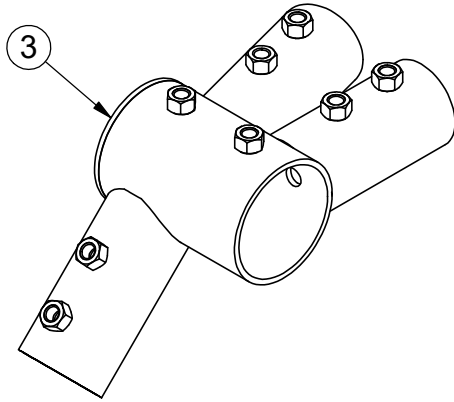
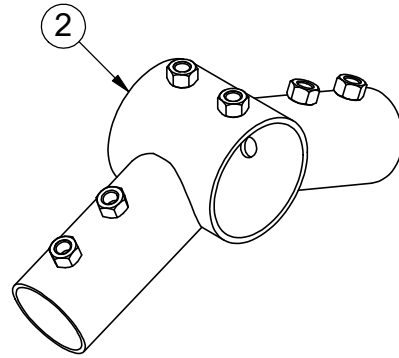
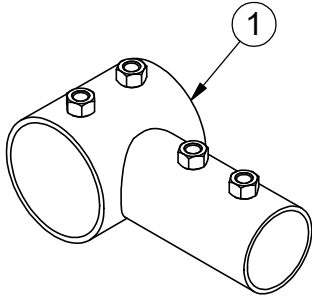

Date: 7/26/2017

Rev: A

Drawn: BDYE

Sheet: 3 of 11

PRODUCT NAME

ECONOMY BACKSTOP

MODEL NO.

1201-10

INSTALLATION INSTRUCTIONS:

2) Determine location of backstop so the rear panel is perpendicular to a line running from 2nd base through home plate & so the wings are parallel with the sides of the diamond.

3. Dig holes according to Footing Plan below & Footing Detail on sheet #4. Start with an end post & center the post in the hole so it rests on the block. Adjust block height as necessary to achieve proper post height. Plumb & brace in position. Repeat the same procedure for the rest of the Vertical Post. Vertical Post are Items (7) (8)

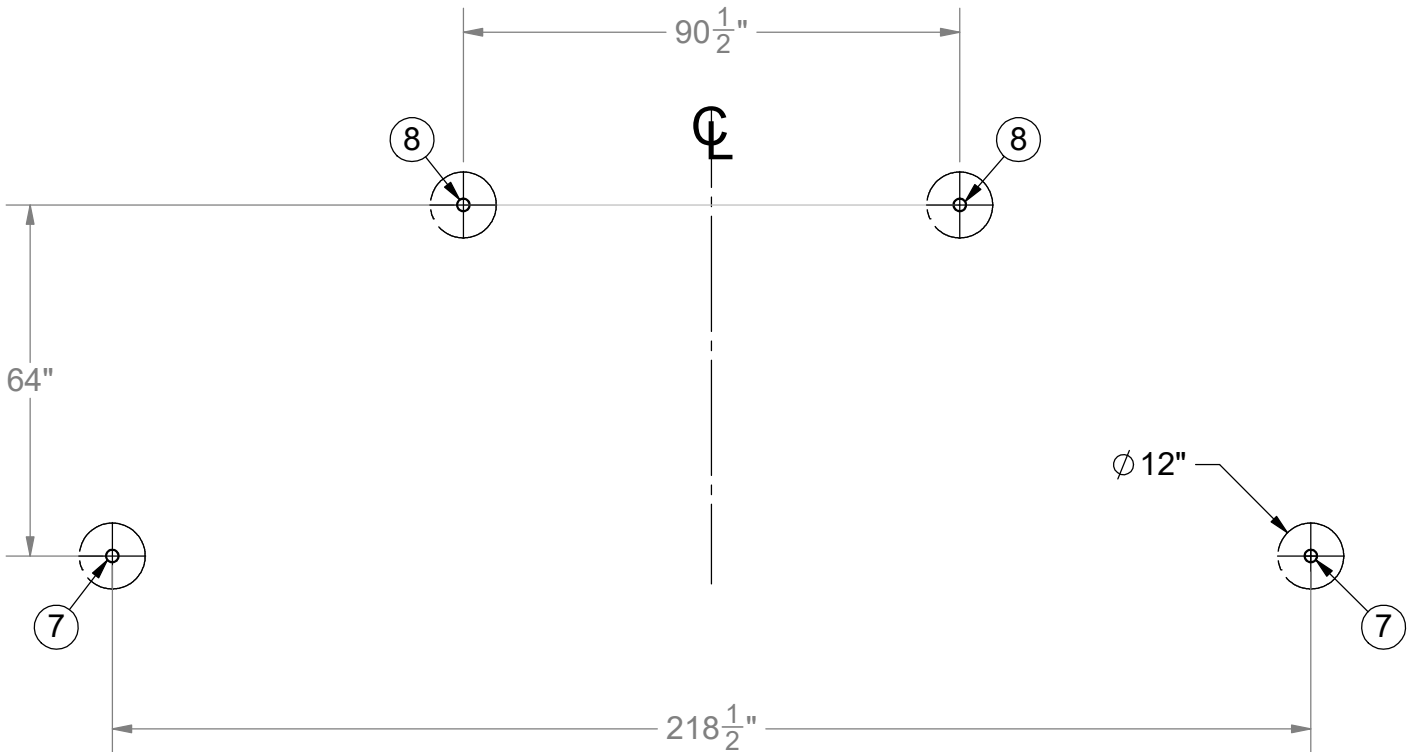

FOOTING PLAN



Date: 7/26/2017
Rev: A
Drawn: BDYE
Sheet: 4 of 11

PRODUCT NAME

ECONOMY BACKSTOP

MODEL NO.

1201-10

Extremely Important

Dig footing holes according to layout & assemble post and rails with supplied pipe fittings.
Do not pour concrete until entire frame is assembled.

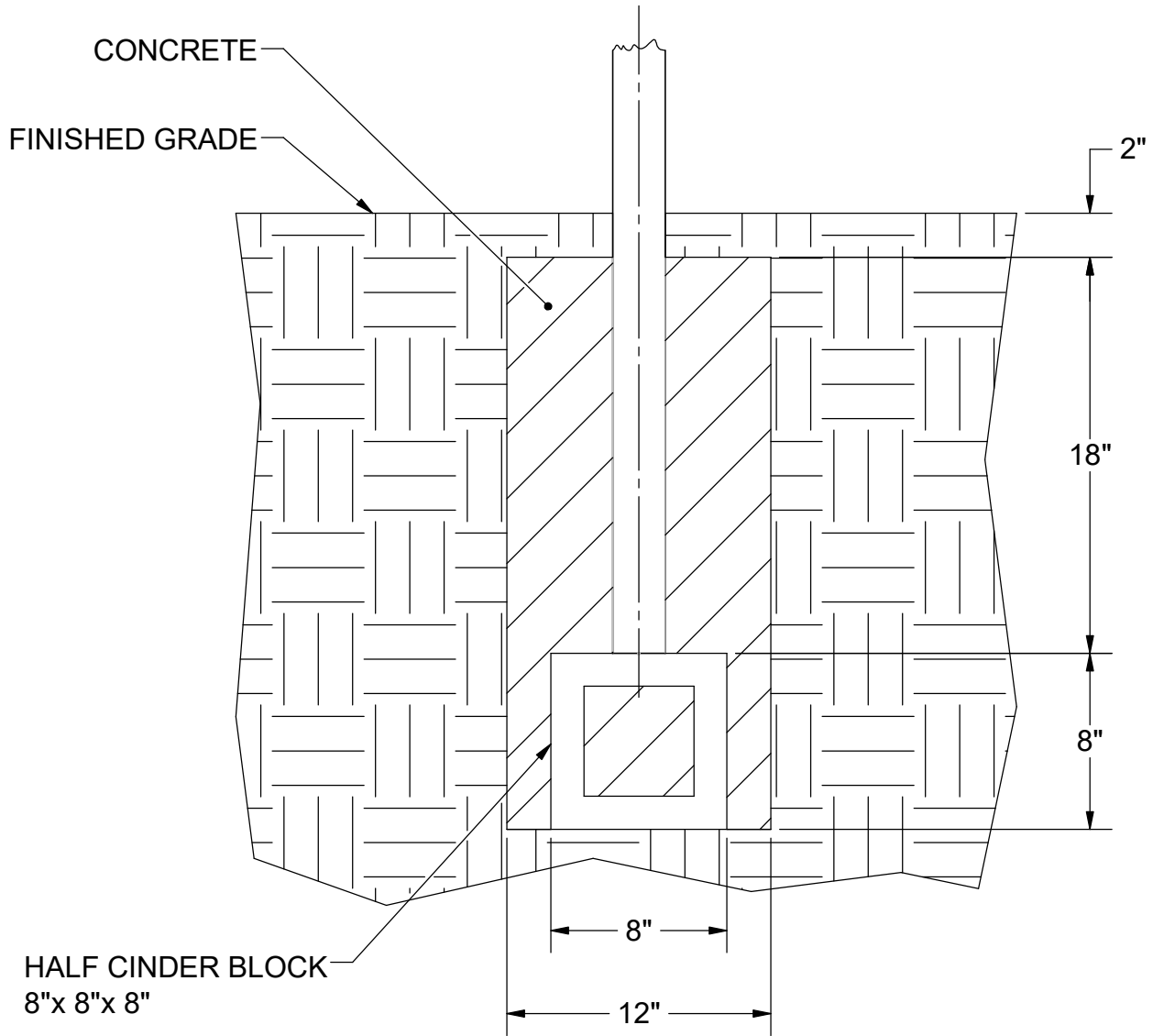

FOOTING DETAIL



Date: 7/26/2017
Rev: A
Drawn: BDYE
Sheet: 5 of 11

PRODUCT NAME

ECONOMY BACKSTOP

MODEL NO.

1201-10

INSTALLATION INSTRUCTIONS:

4) Put the entire Backstop together starting with the bottom first working from left to right. Slide Fittings (1) over Vertical Post in the order shown. Tighten down Items (1) & (3) using 3/8"x 5/8" Set Screw Item (13). Leave Fittings (2) & (4) finger tight also using 3/8"x 5/8" Set Screw Item (13).

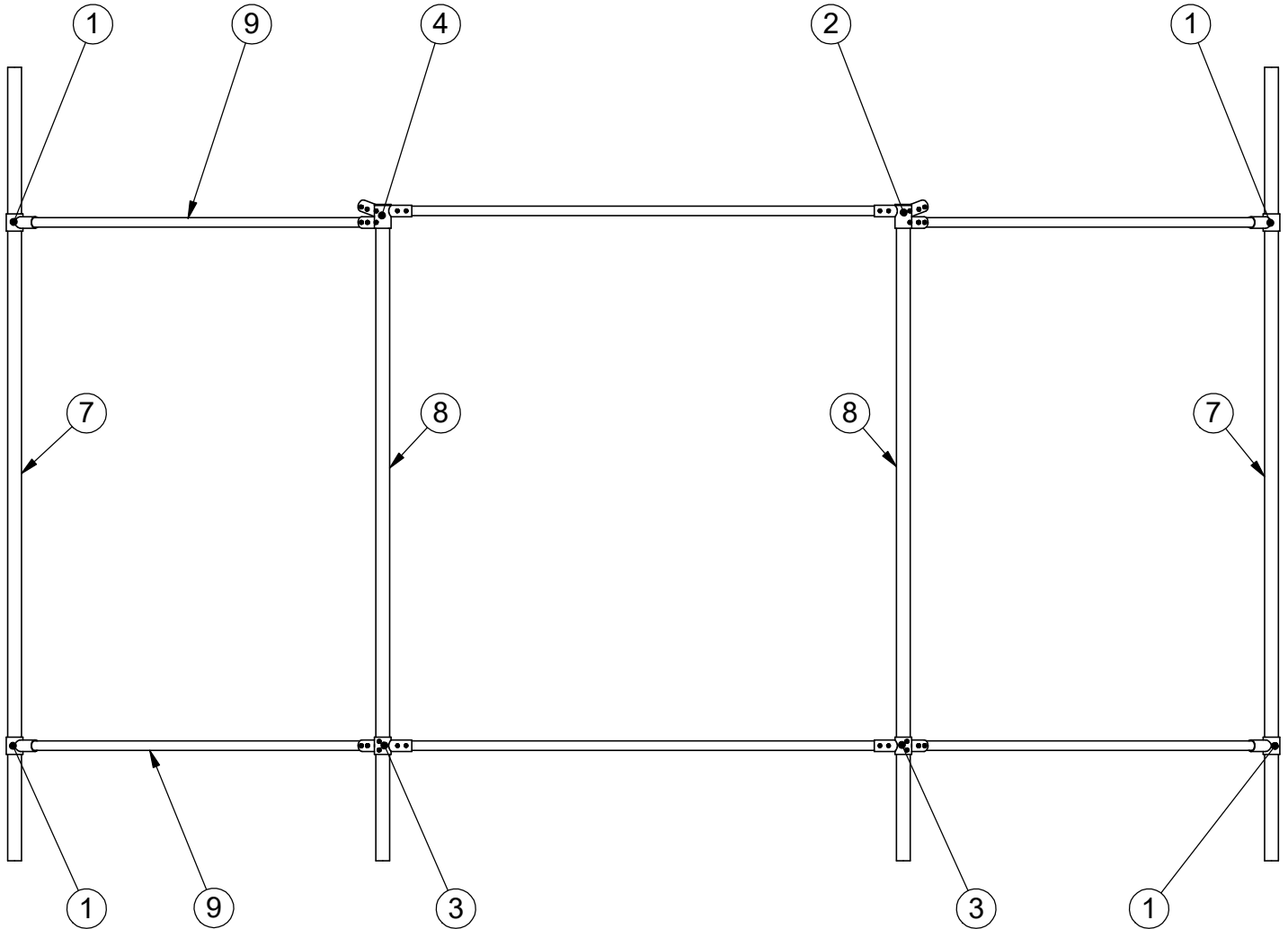

REAR VIEW



Date: 7/26/2017

Rev: A

Drawn: BDYE

Sheet: 6 of 11

PRODUCT NAME

ECONOMY BACKSTOP

MODEL NO.

1201-10

INSTALLATION INSTRUCTIONS:

5) After step 4 is completed install the hood to the Backstop starting with Item (10) only finger tighten the 3/8"x 5/8" Set Screws Item (13)

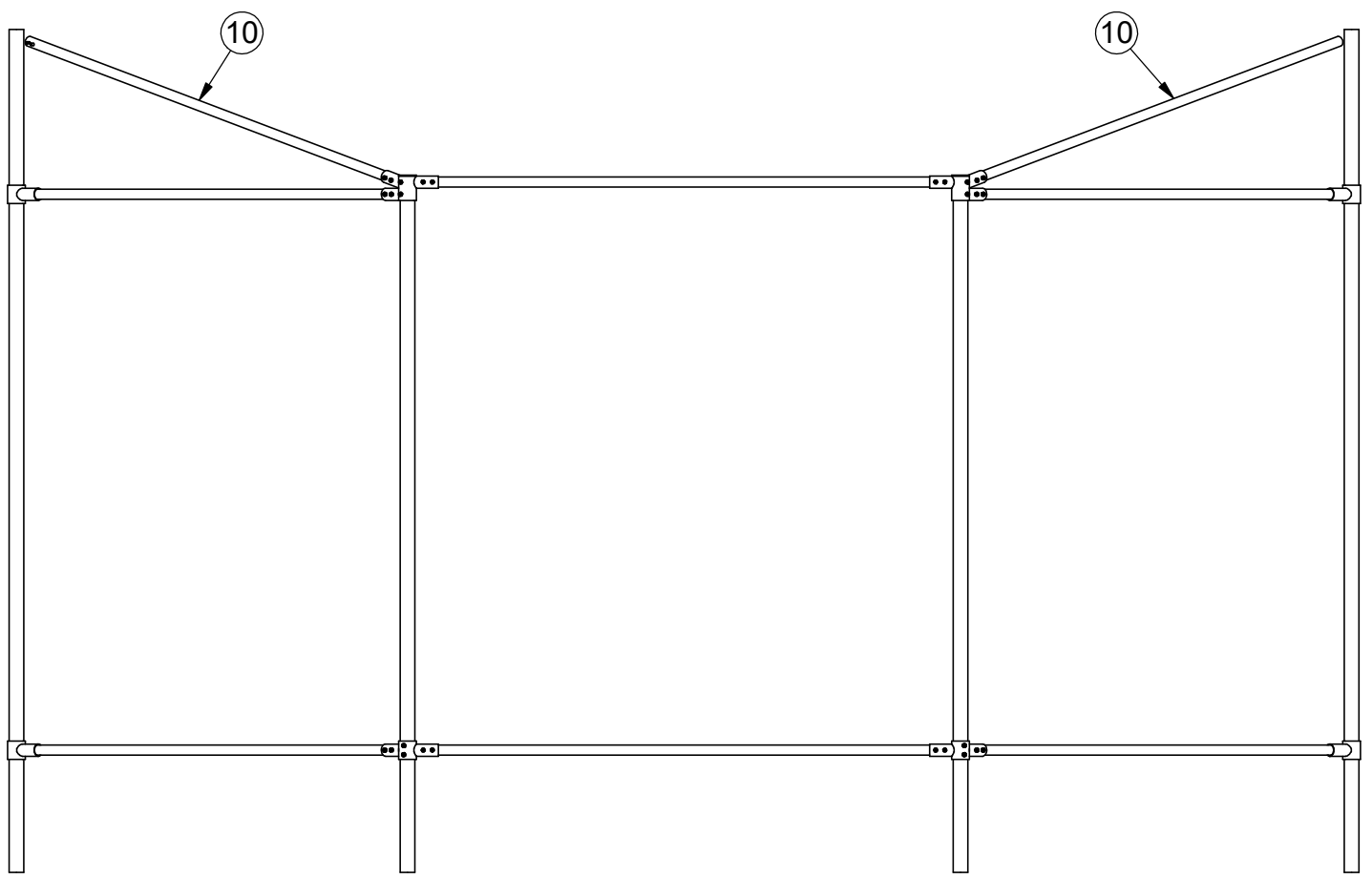

REAR VIEW



Date: 7/26/2017
Rev: A
Drawn: BDYE
Sheet: 7 of 11

PRODUCT NAME	ECONOMY BACKSTOP
MODEL NO.	1201-10

INSTALLATION INSTRUCTIONS:

6) Take the Hood Crossbar Item (11) and lay it on the ground in front of Backstop. Slide Fittings Items (5) & (6) over the ends of the Hood Crossbar Item (11) as shown below. Finger tighten the four Set Screws Item (13) that engage the Hood Crossbar. The remaining Set Screws should only be screwed in enough to hold them in place.

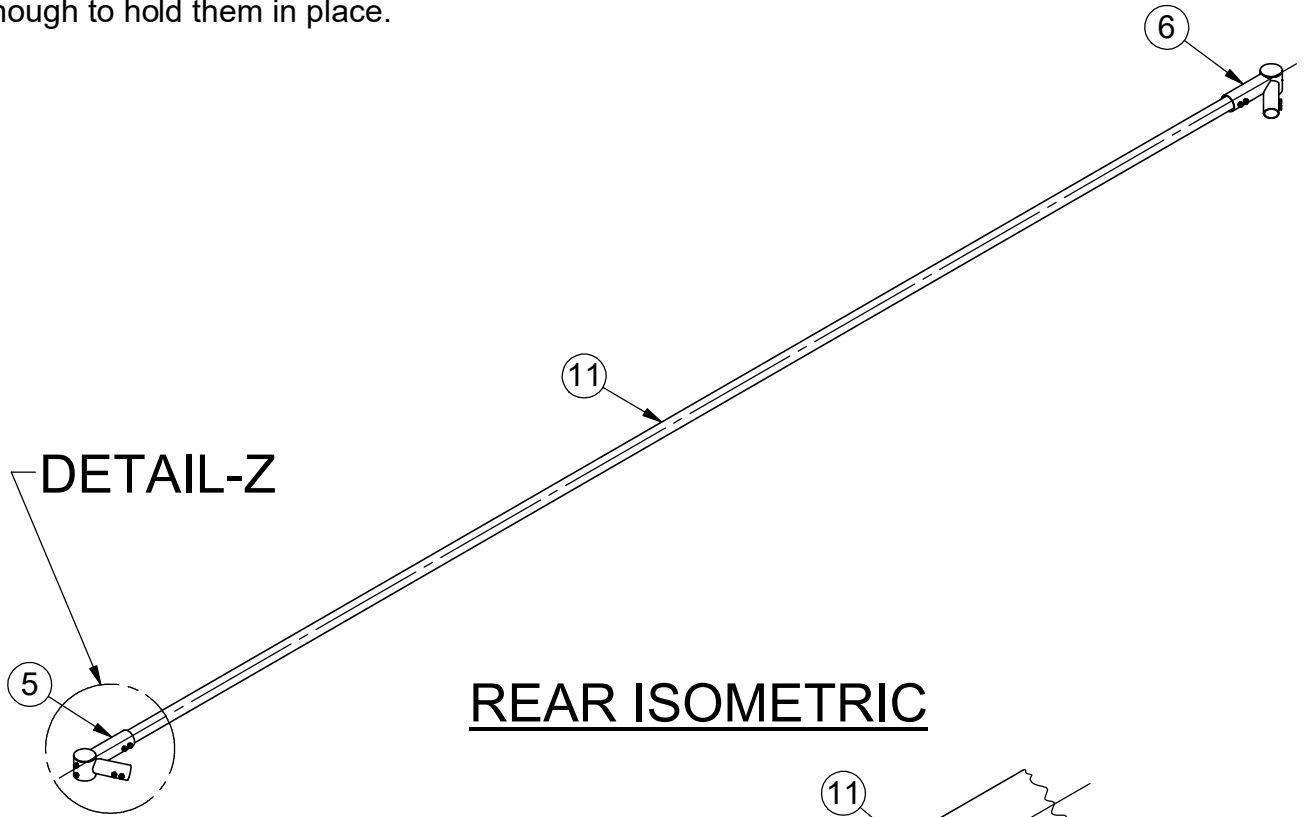

REAR ISOMETRIC

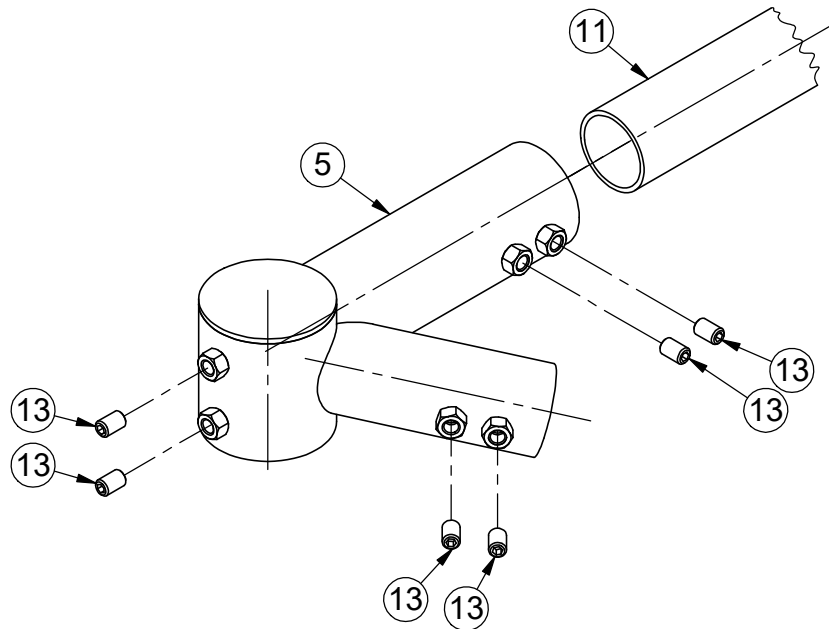

DETAIL-Z
ENLARGED



Date: 7/26/2017
Rev: A
Drawn: BDYE
Sheet: 8 of 11

PRODUCT NAME

ECONOMY BACKSTOP

MODEL NO.

1201-10

INSTALLATION INSTRUCTIONS:

7) Install the Hood Crossbar Item (11) by sliding the Fittings over Item (10) & (7) . Tighten the 3/8"x 5/8" Set Screws Item (13) . Go through the entire Backstop frame and tighten all Set Screws and Drill adapter fittings with #25 drill bit provided. Hammer #10 x 1/2" drive screws into holes until seated. Secure all other adapter fittings in the same manner and tighten all set screws.

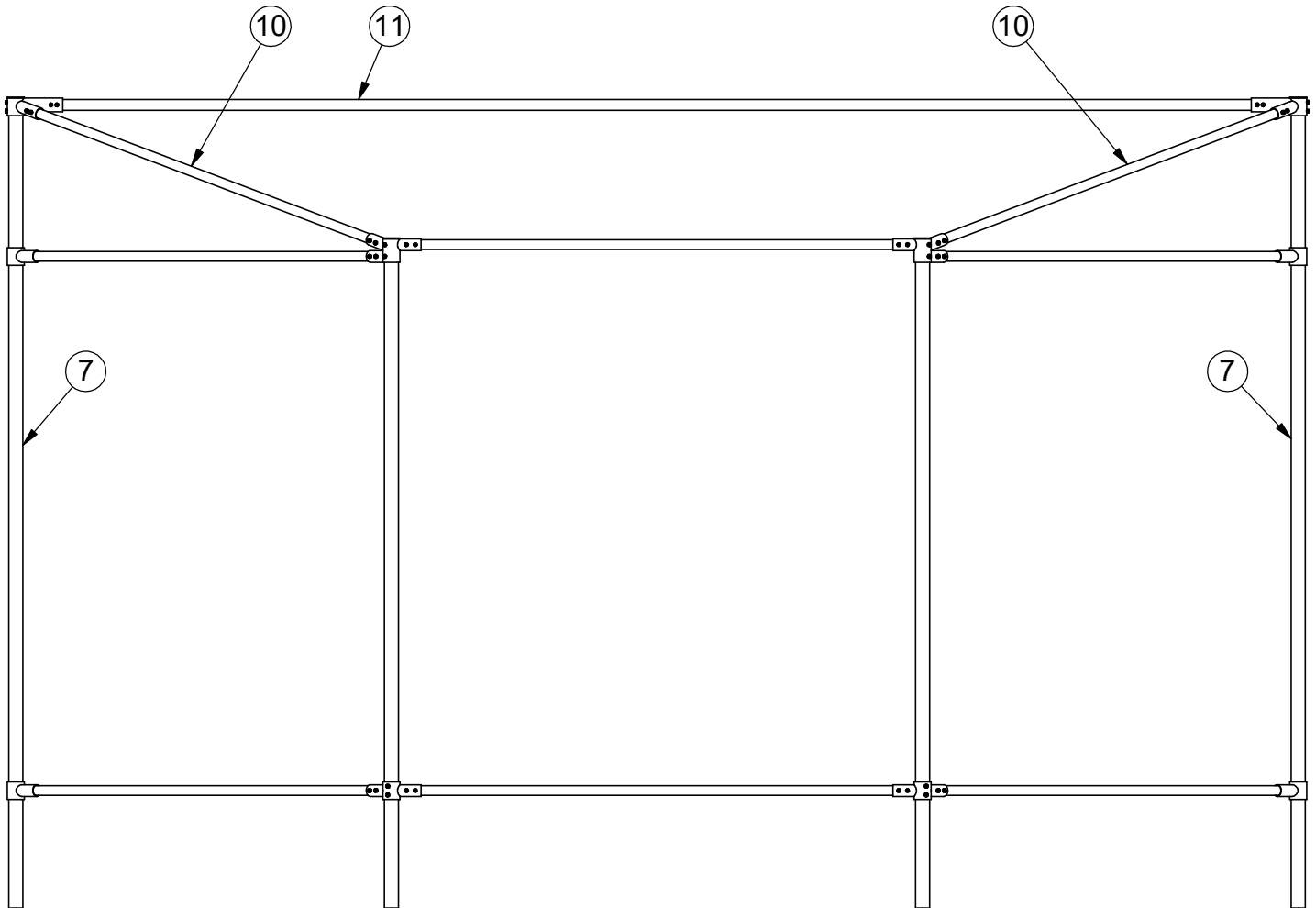

REAR VIEW

INSTALLATION INSTRUCTIONS:

8) Pour concrete up to 2" of finish grade and let set for three days before removal of bracing.



Date: 7/26/2017

Rev: A

Drawn: BDYE

Sheet: 9 of 11

PRODUCT NAME

ECONOMY BACKSTOP

MODEL NO.

1201-10

INSTALLATION INSTRUCTIONS:

7) Install the Mesh Supports Item (12) by slipping Brace Bands over Items (9) & (11) . Then slide Pipe Ends Item (20) on to the ends of the Mesh Supports Item (12) and bolt together using 3/8"x 1 1/4" Carriage Bolt Item (16) , Washer Item (14) and Lock Nut Item (15) shown below.

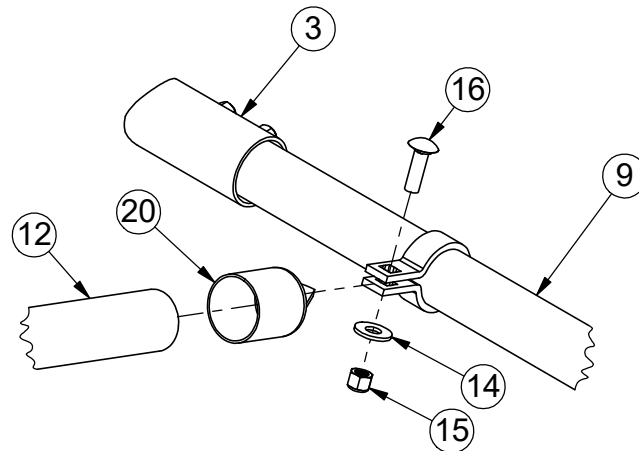
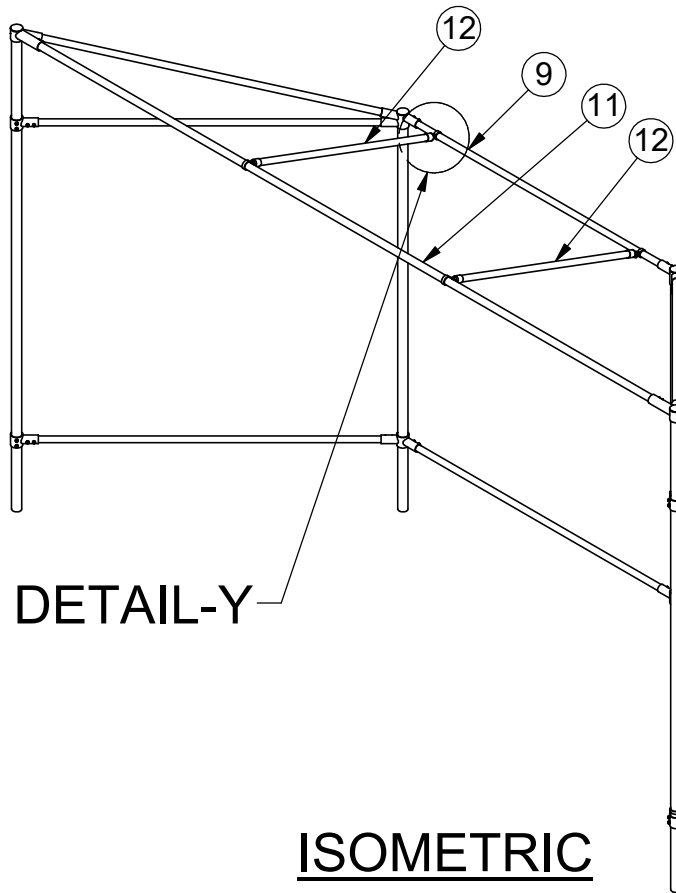

Date: 7/26/2017

Rev: A

Drawn: BDYE

Sheet: 10 of 11

PRODUCT NAME

ECONOMY BACKSTOP

MODEL NO.

1201-10

INSTALLATION INSTRUCTIONS:

9) Install Mesh

1. Cut one piece of mesh (2" X 9ga X 8') 7'-6" long to be installed between the rear vertical posts Item ⑧ . Attach the piece of mesh using one 8' long tension bar on each side of the mesh along with tension bands and carriage bolts provided. Use tension bands on 18" to 20" centers (6 bands for each side of mesh). The mesh must be tight. Remove one or two strands from ends as necessary to achieve proper tension.
2. Cut two pieces of wire mesh (2" X 9ga X 10') 7'-6" long to be installed between the front and rear posts Items ⑧ & ⑨ . Use an 8' long tension bar along the rear vertical post and a 10' long tension bar along the front vertical post. Attach each piece of mesh to the posts using tension bands and hardware provided (6 bands for each rear post and 7 bands for each front post). The mesh must be tight; remove one or two strands from ends as necessary to achieve proper tension.
3. Cut the top of the mesh on the bias where it extends over the top hood rails. Twist the cut ends around each other to prevent the mesh from unraveling. Secure the mesh to the rails along the bias cut with tie wire every 8".
4. Secure the top of the mesh between the rear posts to the horizontal rail with the tie wire every 12".
5. Secure the bottom of the mesh to the bottom horizontal rails with the tie wire every 12".
6. Secure the mesh to the horizontal rails with the tie wire every 12".
7. The remaining piece of mesh is cut to approximate size for the hood. Position the mesh so the widest section is along the top hood rail. Stretch the wire from side to side to determine if any strands need to be removed to achieve a proper fit; if so, the easiest method is to remove the strands from the center and splice the mesh back together rather than cut the mesh on the bias and twist the cut ends back together.
8. Center the mesh on the hood so the front edge is flush with the top hood rail. Secure the mesh in the center with tie wire. Stretch to each side while securing the mesh to the top hood rail every 8". Pull the mesh outward and secure around the perimeter to the three outer rails every 8" with tie wire.
9. Secure the mesh to the hood rail with tie wire every 12".
10. Inspect backstop for loose hardware and tighten as necessary. Some excess hardware is included and should be saved for maintenance purposes. Look for sharp wires and either cut or turn back into the mesh. Cover footings with turf or dirt.



Date: 7/26/2017

Rev: A

Drawn: BDYE

Sheet: 11 of 11

PRODUCT NAME

ECONOMY BACKSTOP

MODEL NO.

1201-10