

# SITE FURNISHINGS

**MODEL 3106-06** - 6FT. STEEL SHEET BENCH WITH BACK (230 lbs)

**MODEL 3106-08** - 8FT. STEEL SHEET BENCH WITH BACK (285 lbs)

## SPECIFICATIONS:

- SEAT:** One piece assembly with 3/16" steel sheet rolled to form seat and welded to 1-5/8" heavy duty steel underneath and 1-7/8" heavy duty steel tube on top of bench
- END FRAMES:** One piece 3/8" x 2" steel bar rolled and welded to form a durable frame. Weld solid square steel bar (4" long) in location provided. Weld top end frame steel round bar connector.
- HARDWARE:** All hardware is Stainless Steel.
- FINISH:** Super durable polyester powder coat.

3106-06-08	
2	END FRAMES
1	SEAT ASSEMBLY
6	3/8" X 3/8" SS SET SCREW

FOR POWDER COAT COLORS SEE  
BACK-INSIDE COVER OF  
PATTERSON-WILLIAMS CATALOG

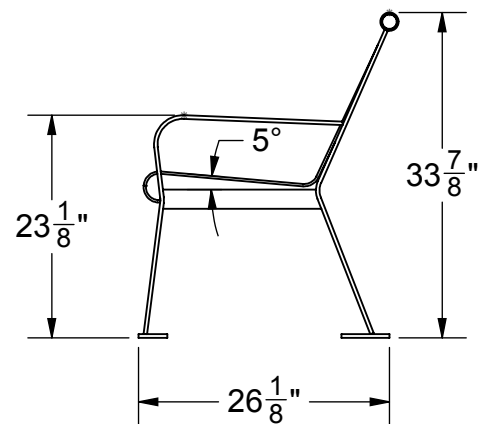
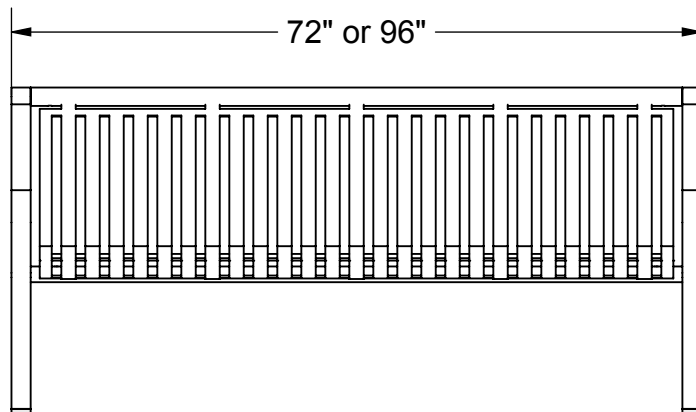
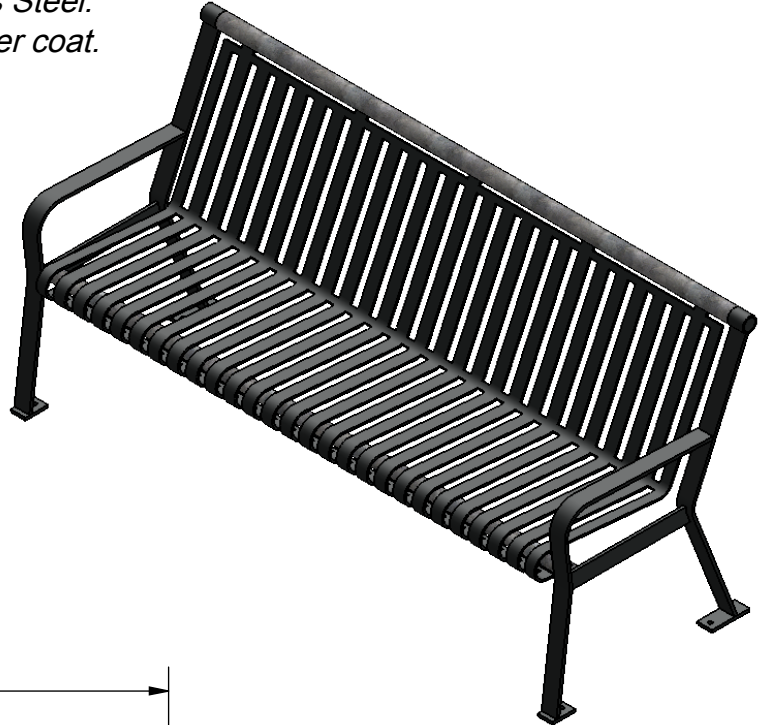

- Attach each End Frame and Center Frame to the seat assembly with (6) 3/8" x 3/8" set screws. (Finger Tighten Only)
- Set bench into final position, align and then tighten all hardware.

**(Note: Bench must be anchored. Anchoring hardware not included.)**



SITE FURNISHINGS

DATE: 8/28/15

REV: 2/22/17

DRAWN: MT

SHEET: 1 of 1

**SPECIFICATION / INSTALLATION INSTRUCTIONS**

STEEL STRAP BENCH WITH BACK

**3106 -06, -08**