

SITE FURNISHINGS

MODEL 3255 - STEEL ROD ASH URN WITH TRAY (69 lbs.)

MATERIAL:

URN: One piece assembly with 1/2" solid steel rod and welded to 3/4" solid steel rod top and bottom.

TRAY: Steel

FINISH: Super durable polyester powder coat.

Ships completely assembled.

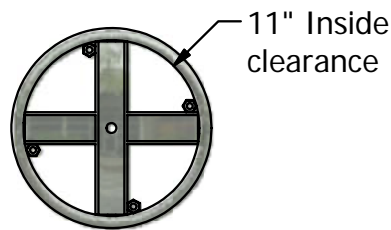
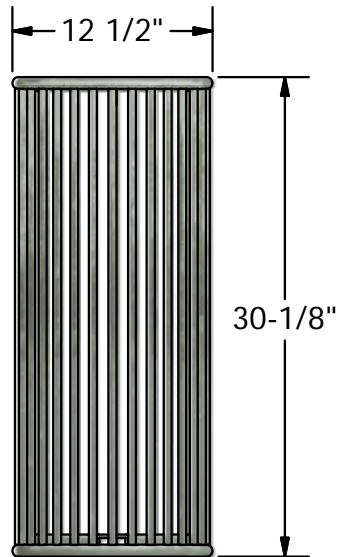

(Note: Ash urn must be anchored.
Anchoring hardware not included.)

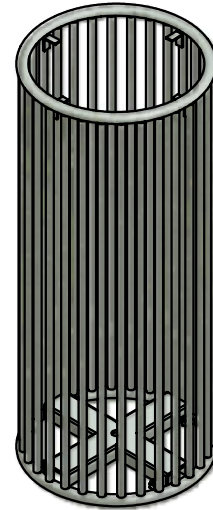

FOR POWDER COAT COLORS SEE
BACK-INSIDE COVER OF
PATTERSON-WILLIAMS CATALOG



STEEL TRAY

	3255 ASH URN
QTY	MATERIAL LIST
1	ASH URN
1	TRAY



SITE FURNISHINGS

SCALE: N.T.S.	SPECIFICATION / INSTALLATION INSTRUCTIONS
DATE: 04-20-11	
DRAWN BY: AMC	
REV.: A071612	
SHEET: 1 of 1	STEEL ASH URN
MODEL 3255	