

PLAYERS BENCH

MODEL 1119-06W - 2" x 12" x 6' ALUMINUM PLAYERS BENCH (28lbs)

GENERAL:

This is a durable bench ideal for dugouts, sideline seating, tennis courts, parks, and schools or anywhere a quality bench is needed. Frames are fabricated from galvanized steel. Seat is made from extruded aluminum.

MATERIAL: All materials are selected for strength, durability and the ability to withstand years of exposure.

SUPPORT POSTS: 2-3/8" O.D. galvanized steel. Two (2) support posts are required for the 21'bench.

SEAT PLANKS: 2' x 12" extruded aluminum with a standard wall thickness of .078", standard height of 1-3/4" and a fluted non-skid surface. Planks secure to each frame with two (2) friction-type aluminum mounting clips.

FINISH: All welds are ground smooth. Aluminum plank finish is clear anodized. All hardware is zinc-plated for long rust free service.



-M1-
PERMANENT
MOUNTING



Leg brace support are required for M2 (Portable) installations only.

-M2-
PORTABLE
MOUNTING

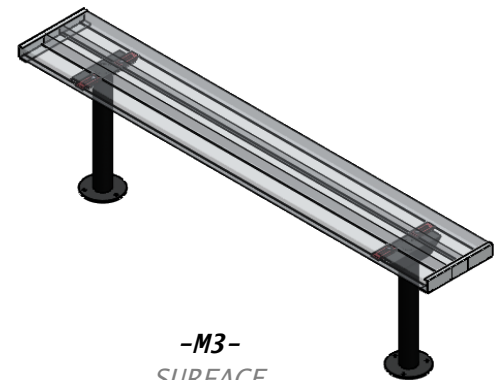

-M3-
SURFACE
MOUNTING

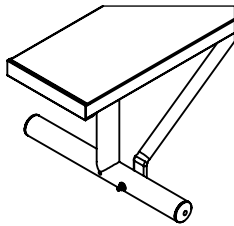

M2
Tube Mount
(W/ Brace)

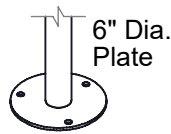

M3
Round Surface
Mount



DC1
1 piece



DC2
2 piece

Optional Designer Plate
Cover for M1 OR M3

NOTE: MOUNTING OPTIONS:

M1 - IN-GROUND MOUNTING

M2 - PORTABLE MOUNTING

M3 - SURFACE MOUNTING

(Note: Bench must be anchored. Anchoring hardware not included.)



SITE FURNISHINGS

DATE: 4/17/19	SPECIFICATION / INSTALLATION INSTRUCTIONS
REV:	
DRAWN: MT	ALUMINUM PLAYERS BENCH W/O BACK
SHEET: 1 of 4	1119 -06W

SITE FURNISHINGS

M1 - IN-GROUND MOUNT

INSTALLATION INSTRUCTIONS:

- 1.) Determine the model of bench to be installed. Use Front View Detail below to determine the distance between support posts for that model and dig the holes for the footings. See Footing Detail below for recommended footing depths.
- 2.) Assemble and align end caps on aluminum planks. Install self-drilling, self-taping tek screws on end caps.
- 3.) Assemble extruded clips on seat supports with 5/16" 1-1/4" carriage bolts, washers and Nylock nuts provided. (See Detail Below) Finger tighten bolts to where nylon begins in nut. Rotate clips 90 deg. to the frame.
- 4.) Lay aluminum plank over plank clips. Rotate plank clips so the grooves lock down on the plank. Tighten bolts to where nylon begins in nut. The first seat support will be approximately 9" from center of support to end of plank. Assemble other seat supports to plank in same manner. Tighten all hardware securely for a solid product.

FOR M1 IN-GROUND MOUNTING:

- 1.) Dig footing holes per M1 permanent mount drawing SHOWN BELOW.
- 2.) Lower the assembled bench into footing holes. Block or shim from below so that top of bench plank is 18" above finish grade.
- 3.) Pour concrete up to 2" of finish grade for a field install or level with finish grade for slab install.

NOTE: Let concrete set for 3 days before removal of bracing. Cover field install footings with turf.

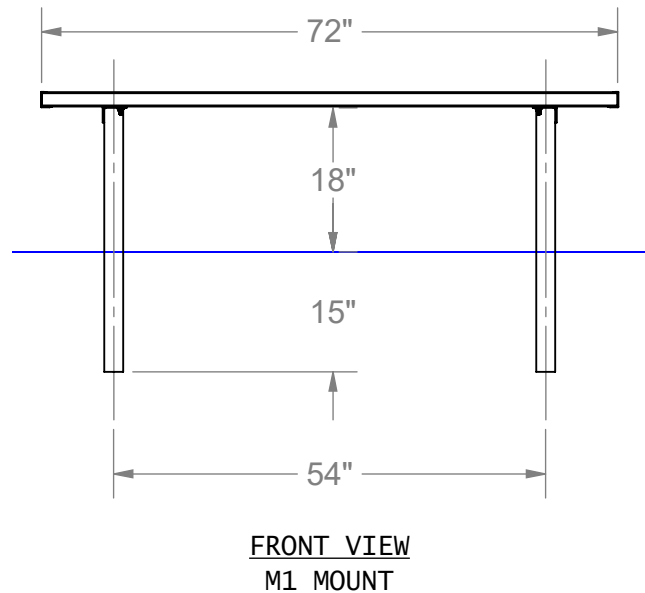
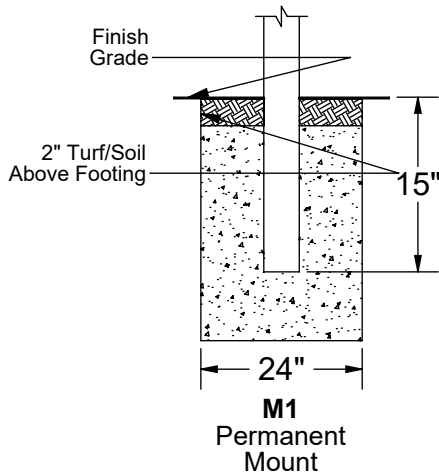

NOTE: Footing sizes are based on average soil conditions. Loose and/or sandy soil is not average and footing sizes must be increased accordingly to meet soil conditions and local building codes and specifications.



SITE FURNISHINGS

DATE: 4/18/19	SPECIFICATION / INSTALLATION INSTRUCTIONS
REV:	ALUMINUM PLAYERS BENCH W/O BACK
DRAWN: MT	
SHEET: 2 of 4	1119 -06W

SITE FURNISHINGS

M2 - PORTABLE MOUNTING

INSTALLATION INSTRUCTIONS:

- 1.) Determine the model of bench to be installed. Use Front View below to determine the distance between support posts for that model.
- 2.) Assemble and align end caps on aluminum planks. Install self-drilling, self-taping tek screws on end caps.
- 3.) Assemble extruded clips on seat supports with 5/16" 1-1/4" carriage bolts, washers and Nylock nuts provided. (See Detail Below) Finger tighten bolts to where nylon begins in nut. Rotate clips 90 deg. to the frame.
- 4.) Lay aluminum plank over plank clips. Rotate plank clips so the grooves lock down on the plank. Tighten bolts to where nylon begins in nut. The first seat support will be approximately 9" from center of support to end of plank. Assemble other seat supports to plank in same manner. Tighten all hardware securely for a solid product.

Portable Mount Option:

1. Install bench braces to frames using 3/8" x 3" Hex Bolt. See Detail A-A below. Insert bolt through frame, holding bolt in place assemble one end of brace over bolt and install 3/8" lock nut. Do not tighten nut at the same time, just install until finger tight.
2. Attach the other end of the brace pipe to the bottom of the aluminum plank with two plank clips, with a 5/16" x 1-1/4" carriage bolt and nut. Repeat for the 2nd brace.
3. Plumb braces to planks and tighten all hardware securely so the clips are firmly in contact with the mounting surface.

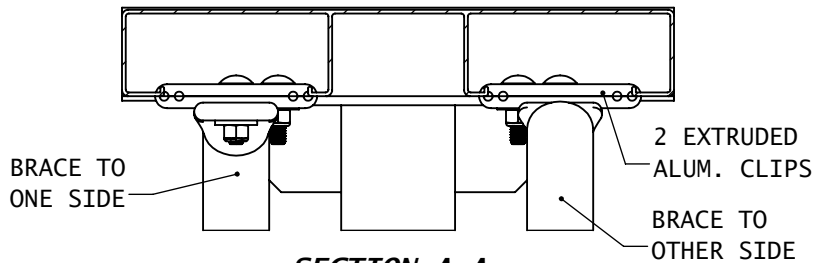

SECTION A-A

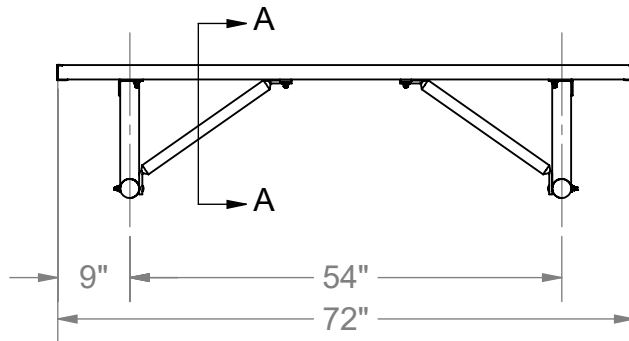

**FRONT VIEW
M2 MOUNT**

M2 PORTABLE MOUNT MATERIALS	QTY
Length of Bench	6'
Bench Frame	2
Brace Pipe 32"	2
Anodized Aluminum Plank	1
5/16" x 1-1/4" Carriage Bolt	4
5/16" x 1-1/2" Carriage Bolt	2
5/16" Lock Nut - Nylock	6
5/16" Flat Washer	4
5/16" Fender Washer	2
3/8" x 3" Hex Bolt	2
3/8" x 3-1/2" Hex Bolt	1
3/8" Fender Washer	2
3/8" Lock Nut - Nylock	3
Aluminum Plank Clip	8
Aluminum End Cap	2
#10 x 3/4" Tek Screw	4

Leg brace support are required for M2 (Portable) installations.

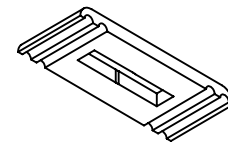

**EXTRUDED
ALUMINUM CLIP**



SITE FURNISHINGS

DATE: 4/18/19

REV:

DRAWN: MT

SHEET: 3 of 4

SPECIFICATION / INSTALLATION INSTRUCTIONS

ALUMINUM PLAYERS BENCH W/O BACK

1119 -06W

SITE FURNISHINGS

M3 - SURFACE MOUNTING

INSTALLATION INSTRUCTIONS:

- 1.) Determine the model of bench to be installed. Use Front View below to determine the distance between support posts for that model and dig the holes for the footings. See Detail A on sheet 2 for recommended footing depths.
- 2.) Assemble and align end caps on aluminum planks. Install self-drilling, self-taping tek screws on end caps.
- 3.) Assemble extruded clips on seat supports with 5/16" 1-1/4" carriage bolts, washers and Nylock nuts provided. (See Detail Below) Finger tighten bolts to where nylon begins in nut. Rotate clips 90 deg. to the frame.
- 4.) Lay aluminum plank over plank clips. Rotate plank clips so the grooves lock down on the plank. Tighten bolts to where nylon begins in nut. The first seat support will be approximately 9" from center of support to end of plank. Assemble other seat supports to plank in same manner.
- 5.) When all hardware is tightened flip bench over and secure to footings or already existing concrete slab with anchor bolt hardware. (Not Included)

Surface Mount Option:

1. Follow Steps 2-4 above to assemble bench. Secure bench to ground using the holes provided in mounting plates. Hardware for surface mount is not provided.

M1, M3 MOUNT MATERIALS	QTY
<u>Length of Bench</u>	<u>6'</u>
Bench Frame	2
Anodized Aluminum Plank	1
Aluminum End Cap	2
#10 x 3/4" Tek Screw	4
Aluminum Plank Clip	4
5/16" x 1-1/4" Carriage Bolt	4
5/16" Lock Nut - Nylock	4
5/16" Flat Washer	4

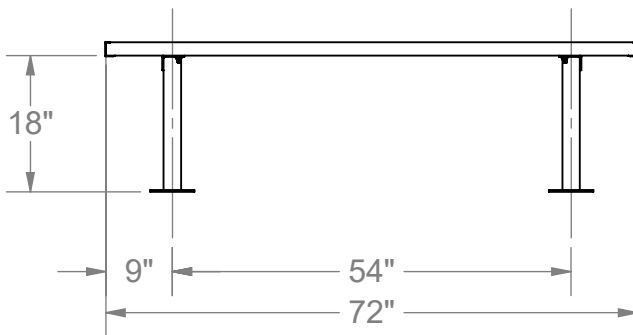

FRONT VIEW
M3 MOUNT

NOTE: Footing sizes are based on average soil conditions. Loose and/or sandy soil is not average and footing sizes must be increased accordingly to meet soil conditions and local building codes and specifications.



SITE FURNISHINGS

DATE: 4/18/19	SPECIFICATION / INSTALLATION INSTRUCTIONS
REV:	ALUMINUM PLAYERS BENCH W/O BACK
DRAWN: MT	
SHEET: 4 of 4	1119 -06W